

SAFEMASTER Installation Guide for

HORIZONTAL LIFELINE VERTIC

COMPLIES WITH EN795 CLASS C



Read Entire Handbook before installing any Safemaster Product. All Products must be installed in accordance with Safemaster's Installation Handbook, using only products supplied by Safemaster. Failure to follow all warnings and instructions may result in a serious injury or death.

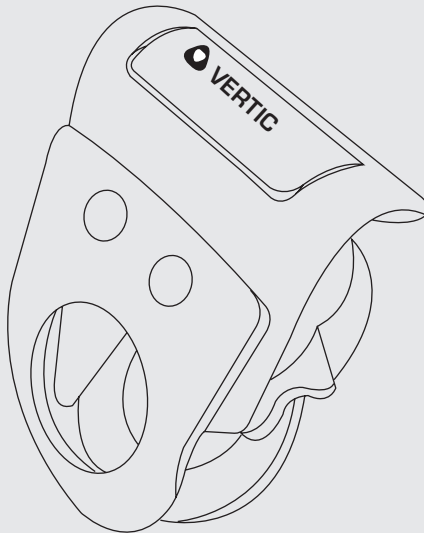

Safemaster
SAFETY PRODUCTS®



INTRODUCTION

A lifeline is a horizontal flexible anchor device that allow continuous movement at heights, in complete safety. Designed to be a permanent installation, it may be secured to a diverse range of structures and is designed to protect one or more individuals simultaneously.

WARNING

The Vertic Lifeline must be installed by Safemaster or one of its approved installer's, trained in the design and installation of the Vertic Horizontal Lifeline.

Prior to installation, it is mandatory to verify the suitability of the structure to accept any subjected loadings.

When installing the Vertic Horizontal Lifeline System, all safety procedures must be complied with in accordance with the current Code(s) of Practice and any relevant Australian Standards.



**READ CAREFULLY SOMEONE'S LIFE
DEPENDS ON IT.**

COMPOSITION OF THE HORIZONTAL SYSTEM

The horizontal fall arrest device VERTIC, includes:

- Anchorage device that will be installed permanently on the structure,
- One mobile fall arrest slider that allows it to pass the intermediate support at a distance: CMS3

These components cannot be used separately. The system has been certified and can only be used if these two types of equipment are used together.

The intermediate structural anchors will have to be designed in order to take a minimum load of 12kN (breaking resistance).

The extremity or corner structural anchors will have to be designed in order to take a minimum load of 40kN (breaking resistance).

The installer must make sure that the support materials in which the anchorage device is going to be installed are adapted for this.

Personnel Protective Equipment (PPE)

Each Vertic Horizontal Lifeline System is designed for use with a certain type of PPE (restraint or fall arrest), according to site specific factors.

The PPE should be collated and documented as part of any handover upon completion.



COMPOSITION OF THE LIFELINE SYSTEM

The VERTIC Lifeline system includes the following:

- Tensioner with extremity to be swaged, or swagless tensioner
- Pretensionner
- Shockabsorber (If required by the calculation programme)
- Extremity to be swaged, or swagless terminal
- Intermediate brackets (to be installed following the implementation drawing)
- Corner part (optional) (to be installed following the implementation drawing)
- Safety Sign
- X metres of stainless steel wire rope
- 1 mobile safety runner

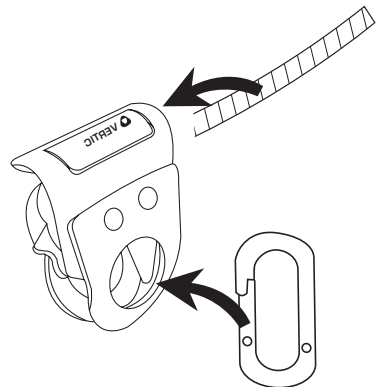
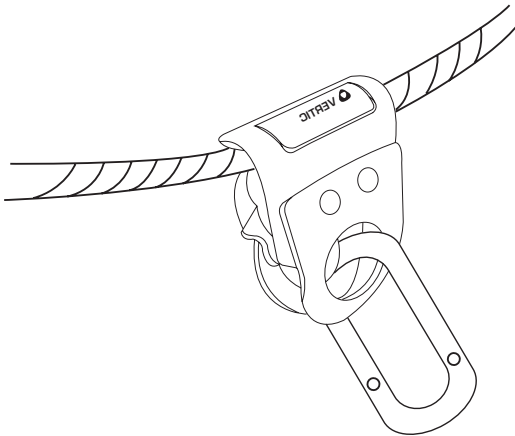

Safemaster cannot be held responsible for any product that is not installed correctly. Person installing Safemaster Products must be approved 'Safemaster Products' installers. All persons installing Safemaster Products must know the 'Working At Heights' Regulations, have had Height Safety Training & be competent in all the relevant Australian Standards applicable to the work you are doing. Any installation diagrams are Safemaster recommended methods and must be adhered to. Safemaster cannot be held responsible for incorrect installation documentation or procedures. Safemaster will endeavour to help and give guidance where necessary but cannot be held responsible for any 'mis-interpretations' or 'incorrect' advice. Safemaster cannot warrant the structure to which the product is connected to. Assessment must be made by a qualified structural Engineer, unless it is clear to a competent person that it is structurally adequate. E.S.O.E applied to all Safemaster Documentation.

If you are uncertain and need help, please email: info@safemaster.net.au or Phone: **(08) 6218 5158** or visit our website: www.safemaster.net.au